

**DISCONTINUED PRODUCT – Push plate L for start/stop flush**  
**(Code no. 16.021.01..0000) (from 1994 to 2010)**

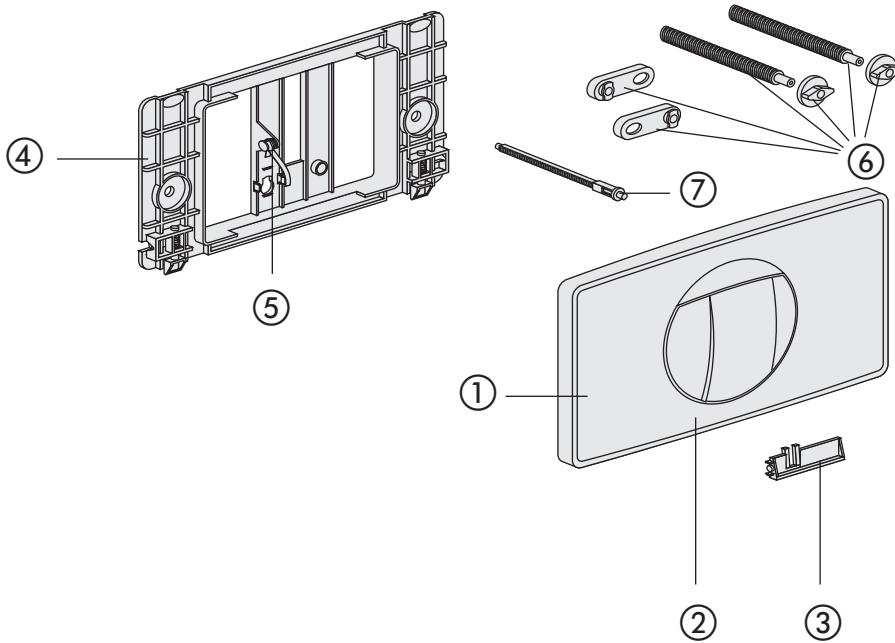

No.	Name	Code No.
1	Push plate, white-alpin	16.021.01..0000
2	Push button with frame, white-alpin	03.124.01..0000
3	Bridge	02.999.00..0000
4	Support bracket	03.125.00..0000
5	Flat spring	02.740.00..0000
6 *	Fastening set	01.020.00..0000
7	Actuating bolts	02.396.00..0000

\* not supplied with push plate no. 1