

16.751.S5..0000

SANIT Push plate Ineo Bright thermosetting plastic black /matt chrome

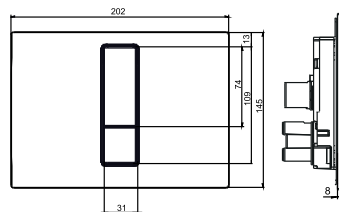
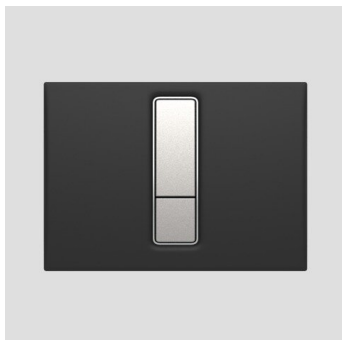

Item number

16.751.S5..0000

Product description

Push plate INEO BRIGHT

I/w/h: 202/145/10 mm, for concealed cisterns with small access opening, dual flush, consisting of actuator element incl. chromed decorative frame, cover plate and fixing bolts, packed in a box

Material: thermosetting plastic black / buttons matt chrome

Note: For the concealed cisterns CC-120-S, CC-150-S and CC-200-S, an INEO universal flush valve code no. 03.982.00..0000 is required prior to series stand 20.