

05.038.00..0000

## **SANIT Installation set for waste + overflow assembly SWING PLUS**

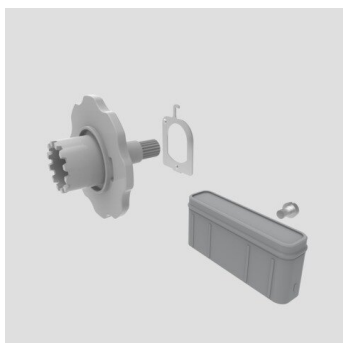

Item number	Product description
05.038.00..0000	Installation set SWING PLUS for waste and overflow assembly SWING PLUS / functional unit SWING PLUS, consisting of fitting holder with removal tool and rectangular aerator with M 3x5 screw (flow rate class C), packed in a plastic bag