

## Waste kits for baths and shower trays 4.4.

### Waste and overflow assembly BASIC and SWING

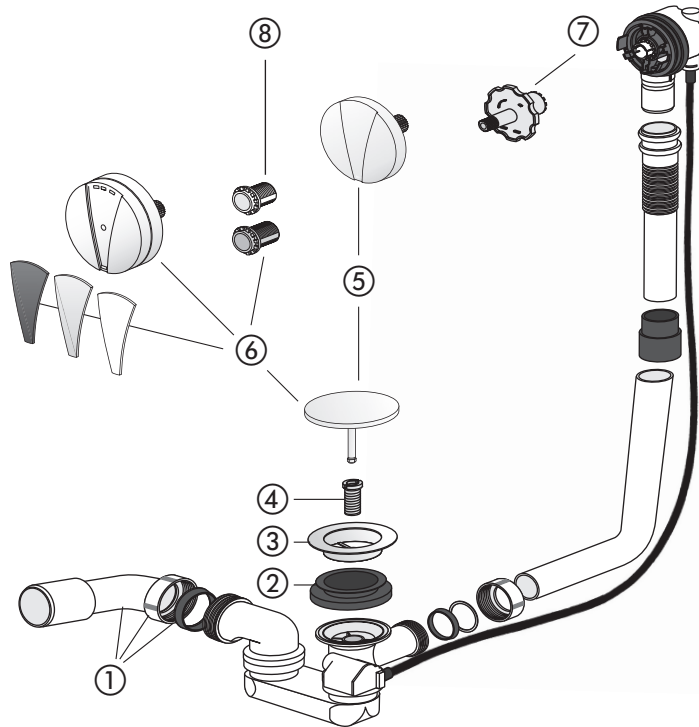

No.	Name	Code No.	Recommended price/€
1	Waste outlet bend with cap nut and 2C conical ring	01.173.00..0000	
2	Collar seal 74 x 48 x 19,4	02.713.00..0000	
3	Waste valve	02.976.00..0000	
4	Screw socket	02.547.00..0000	
5	Operating unit BASIC, chrome	05.097.81..0000	
6	Operating unit SWING, chrome	05.098.81..0000	
7	Assembly key	04.248.00..0000	
8	Screw set	05.172.00..0000	