

Urinal cover plate INEO BRIGHT infrared, mains supply

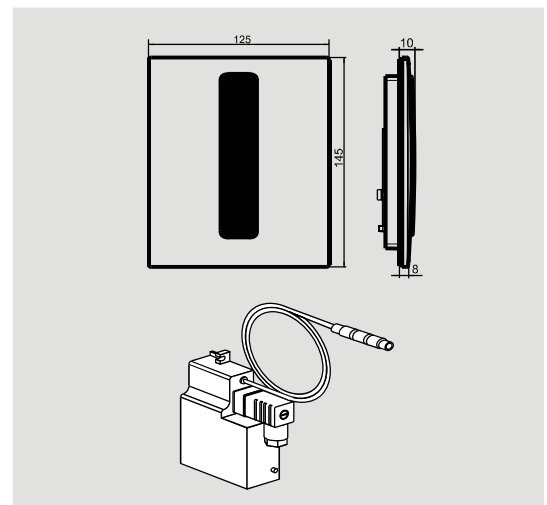
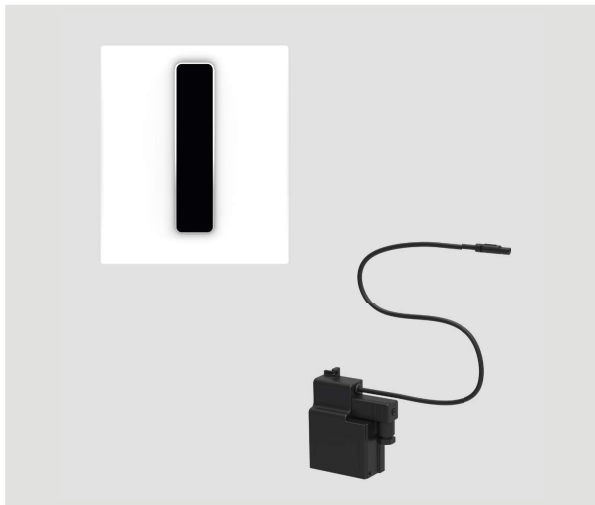

Usage

- for cartridge valve technology
- for use in private and semi-public areas

Features

- contact-free flushing system controlled by infrared sensor

Technical specifications

- flow pressure: 0.5-8 bar
- flow rate: 0.3 l/sec.
- power supply: 6V DC
- sensor range: approx. 0.5 m
- dwelling time: approx. 5 sec.
- main flush: approx. 4 sec.
- hygiene period/hygienic flush: 24 h after last use

Included

- 230V AC/6V DC power supply unit
- cartridge filter
- power supply unit 6V DC
- mounting frame with infrared module and control electronics
- cover plate
- fastenings

Urinal cover plate INEO BRIGHT infrared, mains supply

Accessories

- bidirectional maintenance and service remote control Code no. 03.806.00..0000

Code no.

- 16.091.01..0000 - plastic, alpine white
- 16.091.81..0000 - plastic, chrome
- 16.091.00..0000 - brushed stainless steel